

ANGLE TAP INSTALLATION SYSTEM

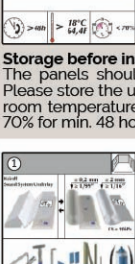

Storage:

Store in the room for 48 hours Aqua Genius Laminate flooring should be stored in draught-free, dry rooms. For transportation it is necessary that the packs are protected from the weather.

Storage before installation:

The panels should be stored unopened in the middle of the room. Please store the unopened Aqua Genius Laminated Flooring packs at a room temperature of at least 18°C (64.4°F) and a relative humidity of $\leq 70\%$ for min. 48 hours.

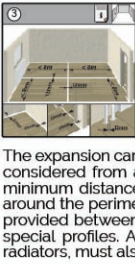

Needed installation tools:

- Vapour barrier: Floor area $+10\%$
- Sound underlay: Floor area $+5\%$, compressive strength (CS) > 90 kPa
- Saw
- Hammer: at least 500 gr.
- Pull bar
- Spacer
- Measuring device
- Pencil



Subfloor requirements

Dry, level, firm and clean sub floor.

Evenness

The sub-floor has to be even max. 3 mm/m (1/8" on 3'). Small differences in floor level can be adjusted with an underlay. Differences in floor level of more than max. 3 mm/m (1/8" on 3') must either be sanded down or filled in with filling/levelling compound.



The expansion gap can reach up to 2 mm/m (1/16" on 3'). This fact should be considered from a construction viewpoint when laying the flooring. A minimum distance of 12 mm (1/2") from the wall must be maintained around the perimeter. Expansion joints of at least 12 mm (1/2") must be provided between rooms. These expansion joints can be covered with special profiles. A distance of 12 mm (1/2") to fixed installations, e.g. radiators, must also be maintained.



Existing Subfloors

Old fixed carpets, Needle felt carpets are unhygienic and too soft for installing laminate flooring over and must be removed. An installation on PVC and linoleum-coating can only be done-, if the floor is glued down and has no loose areas and if there is no underfloor heating.

Cleanliness

The subfloor has to be absolutely clean before installing the laminate and free of any debris.

Installation on concrete/mineral compound subfloor

As the duration of drying depends on climatic conditions, the stated drying periods are to be considered as guidelines. In any case, for safety purposes, two weeks should be added. Absolute certainty can only be guaranteed by adequate measuring e.g.

- CM method (calcium carbide method), Base Drying Period Remaining Humidity
- CM-concrete c.f. week/cm 2,0%
- anhydrite c.f. weeks/cm 0,3%
- pure asphalt from 18 supo/supC
- magnesia c.f. humidity balance
- mineral filler prod. instructions

Installation on wood subfloors

Wooden constructions must be sufficiently ventilated (4cm²/sup. ventilation area per each m²/sup. of flooring). Principally sub-floors consisting of wood (chipboard, hardboard and floorboard etc.) must not be covered with airtight materials as beneath the covering the microorganisms find ideal conditions to exist thereby ruining the floor.

Since sufficient ventilation must be allowed, in sections of the installation near the wall wooden strip must be adjusted to allow for ventilation to pass through floor construction, including after the floor is installed. It must be presumed that the existing hollow/space underneath the construction will be constantly dry, to guarantee the balance of moisture of the wooden construction independent of the seasons, and thereby PE film as vapour absorption will not be needed.

Subfloor

1. PE Film

A PE film (polyethylene film) or similar of at least 0.2 mm thickness must be laid as a vapour barrier against rising moisture. Allow the PE film to overlap by 20 mm (1"). Glue joints together. Pull the film 4-5 cm (1 1/2 - 2") up the wall.

2. Impact Sound Insulation

Part from the acoustic properties, the impact sound insulation system must have a sufficient Compressive Strength. Requirement: CS ≥ 90 kPa ≈ 9 to / m²

We recommend products made of the material XPS (extruded polystyrene hard foam). A combination of impact sound and vapor barrier can also be used.

Laying Direction

Recommended installation direction is lengthwise to the main light source. Flooring consists of several individual boards. The single planks can always be seen in strong light. The joints are more visible crosswise than lengthwise to the light source.

Because of the panel format there are less joints in the length than in the width. This is only recommended because there are also other influences.

Installation in conjunction with underfloor heating

Aqua Genius laminate flooring can be installed in conjunction with hot water underfloor heating systems. In Case that Aqua Genius laminate flooring should be installed in conjunction with electric underfloor heating. Please also see the information sheet on underfloor heating.

Panel mixing

Prepare at least 4 packs of flooring. Mix panels from different packs during installation. We recommend alternate fitting of the panels from four different packs at the same time. Keep alternating the panels across the entire floor area. This guarantees the best possible appearance of your Aqua Genius flooring product.

Check for defective panels

Always carefully inspect the panels for damage before installation. Color, decor, clean edge processing and small damages or visual imperfections on the surface. Panels with minor damage can be used in situations where the panels have to be cut. The installation has to be done using daylight or equivalent good lighting because it can be possible that small damages can't be recognized. No complaints can be accepted in the case of panels which have already been used.



Raw material:

The laminate flooring is manufactured exclusively from timber which is the product of domestic (A and D) forests managed on the basis of permanent sustainability. Sourcing area approx. 500 km.

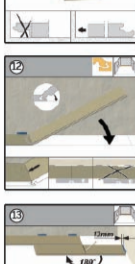

First panel row parallel towards the wall

Please insure a minimum of > 50 mm ($> 2"$) width of the first and last row.

The panels must follow the course of the wall; unevenness 5 mm (1/5") must be marked on the first row of panels using a spacer. The panels have to be sawn lengthways following the marking. The last row of panels at the opposite wall should not be less than 5 cm (2") wide, if so, the width of the first row of panels should be cut down lengthways to avoid this. Please make sure that there is a min. distance to the wall of 12 mm (1/2"). Bear this in mind when calculating the last row.

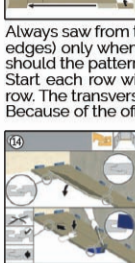

Installation start

Remove the tongue of the first panel row and lay it against the wall.

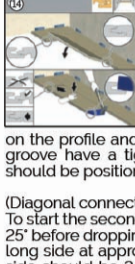

First row

Insert the panel at an angle of approx. 25° degrees and lower the panel to lock into place. Connect the panels of the first row on the short side. Insert the panel into the groove of the first panel at an angle of 25° degrees; and lower the panel to lock it into place. Ensure that the row is straight. Please see also in the installation video.

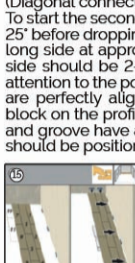

Offset installation

Mark length of last panel in each row to allow for minimum offset to the following rows. For accurate cutting of the last panel in the row, rotate this through 180° degrees; and with the pattern side upwards, place beside the already installed row. Allow for distance from wall at end of panel. Mark out offset and saw off.

Always saw from the upper surface of the panel (to avoid splintering the edges) only when using an electric jig saw or a hand-held circular saw should the patterned side be placed facing downwards. Start each row with the left of the left-over piece from the preceding row. The transverse shocks must be set in an appropriate offset. Because of the offset there is stability in the lay up.

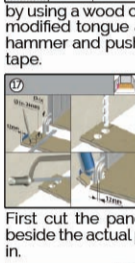

(Longitudinal connection) Angle / Tap:

Place the panel lengthwise at an angle of approx. 25° and angle it in. Shift the panel already now to the short side of the first panel. Push the panel down gently so that the prestressed profile locks in neatly. Pay attention to the positioning of the short sides to ensure the profile pieces are perfectly aligned. Once the plank is lying flat, place the tapping block



Installation with stair-stepping offset:

The panels are laid according to the numbering in the image. (Trim the first row if necessary, as described in Figure 10.) In this sequence, the first 3 rows are laid out in the room. This way of laying ensures that the rows are connected in straight lines.

The pre-installed rows are then pushed against the wall. The distance between the wall and the panel rows is fixed with space wedges. After that, the laying can be continued row by row.



No possibility to angle the panels

Special cases: If you are not able to angle the panels (e.g. under a door frame or low fitted radiator) cut away the locking edge. Glue and tap the panels tight together. If you are not able to angle the panels (e.g. under a door frame or low fitted radiator) you have to cut away the locking edge of lip of the bottom groove

by using a wood chisel or a small block plane. Run a bead of glue on the modified tongue and groove. Tap the panels tight together by using a hammer and push block or pull-bar. If necessary fix it with an adhesive tape.

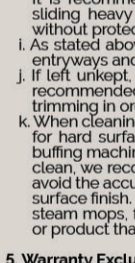

Installation towards heating pipes

(Minimum distance 12 mm (1/2")) Position the panel row so that a transverse joint coincides with the pipe. Join up the sawn off piece again tightly behind the heating pipe (using the spacer). Position the panel row so that a transverse joint coincides with the pipe.

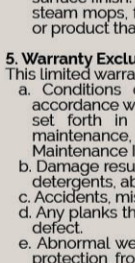

Installation towards wooden door frames

Minimum distance 12 mm (1/2") Lay a panel next to the door frame (with the patterned side facing downwards) Cut into the door frame with the straight back saw. Then slide the panel under the frame with the patterned side upwards. Don't forget to allow for freedom of movement here too 12 mm (1/2").

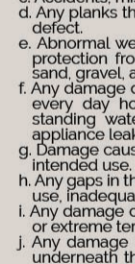

Installation towards metal door frames

Minimum distance 12 mm (1/2") Mark the measurements of the metal door frame on the panel, remember the necessary distance 12 mm (1/2") on each side. Now saw out the marked section. Place the panel and make sure, that the freedom of movement is given 12 mm (1/2").

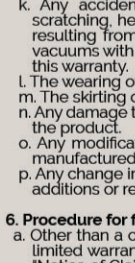

The final panel row

Lay a panel exactly on the previous row. Lay a second panel (original width) on the top of it and draw an exact line for cutting. Cut away excess wood. Join the panel lengthways. Minimum expansion gap 1.5 mm (1/16" on 3") Measure the exact width of the last panel row. To do this lay a panel on the previous panel row.

Then lay a second panel on the panel to be measured with the tongue to the wall and use as a straight edge. Cut away excess wood. Minimum expansion gap 1.5 mm (1/16" on 3"). Insert the panel lengthways and lower down.

MANUFACTURER'S LIMITED PERFORMANCE WARRANTY

1. Residential Limited Warranty.

Kaindl provides the following residential limited warranty:

Kaindl Flooring GmbH ("Kaindl") warrants to the original end consumer that, from the date of purchase through the end of the applicable limited warranty period set forth in the chart above, your AQUApro "Select" collection planks (the "Select planks") and/or AQUApro "Supreme" collection planks (the "Supreme planks"), and together with the Select planks, the "planks"), as the case may be, will be free from manufacturing defects" and, in their original manufactured condition, and under normal household conditions", will (1) not fade due to sun or electrical light, (2) not have their laminated surface wear through", (3) not stain, (4) resist damage from moisture due to wet mopping and every day household spills, and (5) have their joints remain secure. This residential limited warranty is subject to the terms and conditions set forth below and, for the avoidance of doubt, does not apply if used in a commercial setting.

*72 hours top-down surface water resistance warranty
• Unifloor Trading Inc warrants that under normal household use (such as everyday household surface spills, moisture from wet mopping, rainy day wet shoes), and following Kaindl's (the manufacturer) installation and maintenance procedures, Aqua Genius collection laminate flooring will not delaminate or swell more than 8% of its original thickness.
• Manufacturer's warranty exclusions and conditions apply to this warranty.

2. Light Commercial Limited Warranty: Kaindl provides the following light commercial limited warranty:
Kaindl warrants to the original end consumer that, from the date of purchase through the end of the applicable limited warranty period set forth in the chart above, your Select planks and/or Supreme planks, as the case may be, will be free from manufacturing defects" and, in their original manufactured condition, and under light commercial use****, will not (1) fade due to sun or electrical light, (2) have their laminated surface wear through", or (3) stain. This light commercial limited warranty is subject to the terms and conditions set forth below.

*Manufacturing defects means verified problems or defects existing prior to the first shipment of the planks resulting from the manufacture, materials or workmanship of the planks that render the planks unable to function in a manner consistent with and according to the specifications provided by and/or defined by Kaindl that are applicable to the planks.
**Normal household conditions means those daily activities commonly associated with residential use.
***Gloss reduction does not constitute "wear".

****Light commercial use means use in environments which do not have heavy commercial traffic, where the flooring is not exposed to a heavy commercial maintenance schedule and where the interior temperature and humidity can be controlled and maintained. Without limiting the generality of the preceding sentence, light commercial use only includes use in the following commercial areas:
• Apartments, Retail Store Fronts, Medical Offices, Hotels/Motels, Educational/School Facilities, Business Offices, Restaurants, Multi-Family housing, Condominiums;
In each of the aforementioned environments, the following uses are permitted: Entryways, Sales Floor/Showroom, Breakrooms, Office environments, Storage and dressing Rooms, Lobbies, Waiting room areas, Hallways, Nurses Stations, Guest Rooms, Conference/Meeting Rooms, Kitchenettes, Lounges, Offices, Individual Housing/Units, Classrooms, Common Areas, any area not considered as high traffic/heavy commercial.
† It is required to have walk off mats at all entryways.

Use of the product:

Please evaluate the installation site prior to the installation of the planks to determine if additional steps need to be taken to address specific requirements for jurisdictional health and/or specific building codes, static resistance, COF requirements, exposure to frequent water, excessive moisture or heavy traffic, and take necessary steps to ensure a safe and secure installation.

Kaindl does not provide additional warranties other than our limited residential warranty and light commercial warranty. Kaindl accepts no responsibility for usage that is not in compliance with any country, state, county, city or township regulations or codes. Proper assessment of location requirements, regulations and usage, are the responsibility of the installer. Kaindl does not warrant nor guarantee that any of the proposed uses in the aforementioned categories are compliant with local building, health and/or other municipal codes or regulations. Except where expressly implied, the term "limited warranty" refers to only the residential limited warranty and light commercial limited warranty as outlined.

Terms and Conditions:

This limited warranty for the flooring planks is made with respect to the following terms and conditions:

3. Acceptable Installation method

It is required that ALL Kaindl flooring planks be installed correctly and in accordance with Kaindl's Installation Instructions and Sub-Floor Preparation Guidelines. The Installation Instructions are provided in the insert sheet of each box of material and can also be obtained from a Kaindl reseller or by visiting www.kaindl.com.

In accordance with Industry Standards:
A moisture test should be performed prior to installation. Any moisture issues underneath the floor to be installed must be rectified prior to installation. When testing concrete use a calcium chloride moisture test (ASTM F1889), the values must be ≤ 5 lbs./1000ft²/24hr or < 80 g/ft² with an in situ probe (ASTM F2170). If you are installing Kaindl laminate floors over a wood subfloor, a vapor barrier is not required. However, wood subfloors must have a moisture reading $\leq 12\%$ across the complete installation. If attached underlayment is not included, install Kaindl Laminate floors over an underlayment that is approved for use with laminate floors.

a. Any dampness from construction materials, such as moisture in the concrete slab or another sub-floor, must be completely dry prior to installation;

b. proper installation includes the installation of the planks area(s) where they are exposed to normal wear based on their recommended End Use Category according to ISO 10874; and

c. if the desired installation room is an area that is susceptible to spills or liquid getting behind skirting (molding) boards, the perimeter of the room must be completely sealed. A 3/8" compressible polyethylene (PE) foam backer rod should be inserted to fill all expansion spaces. The backer rod should be completely covered with 100% silicone sealant around the entire perimeter of the installation. An acrylic sealant should not be used. A small silicone bead should be applied where the skirting (molding) meets the floor, creating a perimeter barrier to prevent any spills or liquids from getting underneath or behind the skirting. The same result can be achieved with waterproof skirting. Any fixed objects, door frames, etc. should be sealed in the same way using a 100% silicone sealant.

d. It is important that the installer completely engages the locking system on all 4 sides of each plank when installing, so as to avoid any gaps that could potentially void the warranty.

A nonrecycled (100% virgin) minimum 6-mil polyethylene vapor barrier with a density of 0.92 lbs./cubic foot and a thickness tolerance of $\pm 10\%$ is required to be installed over any concrete subfloor. Any vapor barrier that emits a water vapor no greater than 5 lbs./1000ft²/24-hr is an acceptable vapor barrier when installed in accordance with the provided installation instructions.

4. Proper Care & Maintenance

The Kaindl planks must be maintained in accordance with the Kaindl care and maintenance instructions (the "Care and Maintenance Instructions"). A copy of the Care and Maintenance Instructions should be provided to you at the time of purchase or should be obtained through a Kaindl reseller, or by visiting www.kaindl.com. The Care and Maintenance Instructions include, but are not limited to, the following:

a. The planks must be used only indoors in a dry, climate-controlled area.

b. Floor protectors (ex: felt pads) that do not stain should be used to protect the planks. To minimize the possibility of indentations or scratching from the movement of heavy objects, use heavy duty leg bases/rollers. If the object is excessively heavy, a wider floor protector is required.

c. The primary cleaning method that should be used is dust mopping. Mop using only a well wrung out mop and warm water only. Use only non-abrasive soap-free cleaners made specifically for laminate floor care to clean the planks. (NEVER USE: Detergents, soaps, "mop-and-shine" products, waxes, polishes, abrasive pads or cleaners, including nylon scouring pads, steel wool, Comet™, Soft Scrub™, etc. that may damage the finish.)

d. It is not necessary to use a wet mop that will puddle or leave moisture standing on the planks. Any approved cleaning solution used should not be poured directly onto the planks, but instead should be applied to the mop or cloth used for cleaning.

e. For the best cleaning results, use 1 cup of vinegar per gallon of warm water.

f. Any spills should be wiped up immediately. In any event, liquid should not be left on the planks longer than is reasonable.

g. If your home is susceptible to ongoing or frequent intrusion of dirt or sand, it is recommended that you mop, dust mop or vacuum, more frequently.

h. Scratches typically occur when large heavy objects are moved across the floor. Exercise caution when moving large objects or appliances like stoves, refrigerators, furniture or other heavy objects. It is recommended that you use devices or material suitable for sliding heavy objects, never slide heavy objects across the floor without protection for the floor.

i. As stated above in section 2, the use of protective walk-off mats in entryways and in heavier traffic areas is required.

j. If left unkept, your pets nails could cause harm to your floor. It is recommended that you maintain your pet's nails by regularly trimming in order to prevent them from scratching the planks.

k. When cleaning or vacuuming, only use vacuums and tools designed for hard surfaces. It is prohibited to use any type of polishing or buffing machine to clean the floor. It is important to keep your floors clean, we recommend frequent dusting, vacuuming or sweeping to avoid the accumulation of any particles that could dull or scratch the surface finish. It is prohibited to use devices such as floor scrubbers, steam mops, floor buffers, wet jet mops, or any other similar device or product that could damage the surface of the planks.

5. Warranty Exclusions

This limited warranty does not cover:

a. Conditions or defects caused by installing the floor not in accordance with the Instruction Guide or the installation instructions set forth in this limited warranty, or improper use, care or maintenance, including the failure to follow the Care and Maintenance Instructions.

b. Damage resulting from excessively wet maintenance or from using detergents, abrasive cleaners, soaps, waxes or polishes.

c. Accidents, misuse, or abuse (pet damage is abuse).

d. Any planks that are installed which contain a visible manufacturing defect.

e. Abnormal wear such as damage from spiked heel shoes, lack of protection from furniture or hard casters, or surface dulling from sand, gravel, abrasive cleaners, or adhesives or residue.

f. Any damage caused by moisture that occur from events outside of every day household spills, this includes but is not limited to standing water, broken, flooding due to mechanical failure or appliance leaking, urine, pipes.

g. Damage caused due to use of the planks in any way other than the intended use.

h. Any gaps in the joints that are due to improper installation, improper use, inadequate care or maintenance.

i. Any damage caused due to the planks being exposed to excessive or extreme temperatures.

j. Any damage caused by moisture in the subfloor or coming from underneath the floor. This includes, but is not limited to, damage from hydrostatic pressure underneath the floor or any other condition that results in any kind of moisture coming from underneath the floor.

k. Any accidents, improper maintenance or damage caused by scratching, heavy impact or the cutting of the planks. Any damage resulting from the use of floor scrubbers, steam or wet jet mops, vacuums with beater bars, or any similar device is not covered under this warranty.

l. The wearing of the planks under normal use

m. The skirting or moldings.

n. Any damage that is due to the shipment, transportation or moving of the product.

o. Any modifications or the altering of the planks from their original manufactured condition.

p. Any change in the gloss level or sheen variations from later product additions or repairs.

6. Procedure for filing a Claim

a. Other than a claim for a manufacturing defect, any claim under this limited warranty must be made by delivering a notice of claim (the "Notice of Claim") within 30 days of the appearance of the defect to the original reseller (with a copy to Kaindl) where the flooring was purchased. The claim should list the detailed reason for the claim, product specifications, model number and must be delivered to the original reseller (with a copy to Kaindl) along with the original purchase and installation documentation. All claims under this warranty must be made prior to the expiration of the warranty period.

b. Kaindl expressly reserves the right to inspect any alleged defect or have it inspected by its authorized agents, and the right to request photographs, planks for testing, and/or an independent inspection by a certified licensed independent inspector prior to approving any claim.

7. Kaindl's Responsibility under this warranty:

a. If a claim under this warranty is determined justified, Kaindl will repair or replace, at its sole discretion, only the affected flooring planks. Any replacement planks will be provided by the reseller where the original defective planks were purchased.

b. If, in its sole discretion, Kaindl determines that the repair or replacement of the flooring planks is not reasonably achievable, Kaindl, at its sole discretion, may choose to refund the pro-rated (based on square footage) original purchase price of the affected planks, subject to the following applicable adjustments:

(i) in the case of a claim regarding the "Select" quality planks, the pro-rated (based on square footage) original purchase price shall be reduced by 1/4 of its original value for each period of (5) five years or portion thereof that passes from the original date of purchase; or

(ii) in the case of a claim regarding the "Supreme" planks, the pro-rated (based on square footage) original purchase price shall be reduced by 1/5 of its original value for each period of (7) seven years or portion thereof that passes from the original date of purchase (collectively, the "Optional Refund").

c. If a claim is made and the exact product is no longer available, Kaindl will replace, at its sole discretion and in accordance to subsection 5(b) above, the affected planks with another Kaindl design of equal or greater value.

d. Kaindl is not responsible for any labor, materials or other costs associated with the replacement of the affected planks or the installation of (repaired or replaced) planks; with the exception of the optional refund (if any), provided that, if the affected planks were professionally installed, Kaindl, at its sole discretion, will cover reasonable replacement labor costs for the replacement of Kaindl manufactured planks.

e. Once a claim is approved, Kaindl will instruct the manner in which to proceed in order to have the affected planks repaired or replaced, the instructions must be completed within ninety (90) days after the claim is approved or all rights are waived under this limited warranty.

8. Disclaimers

a. This limited warranty is not transferable and applies only to the original end consumer for so long as he or she owns the planks and the original installation site. This limited warranty applies only where the affected area is readily visible and covers an area greater than one square inch.

b. Information concerning the planks contained in Kaindl catalogs, samples, descriptions, advertisements, or other marketing or promotional material or statements made by sales representatives, distributors or retailers are for general informational purposes only and are not binding upon Kaindl and you should not rely on any such information concerning the planks. Sales representatives, distributors or retailers have no authority whatsoever to modify this limited warranty.

c. Any incidental or consequential damages are hereby disclaimed by Kaindl. This limited warranty gives you specific legal rights, you may have other rights that vary from state to state. Some states do not allow the exclusion or limitation of incidental or consequential damages, so the above limitation or exclusion may not apply.

d. If any part of this warranty is determined to be invalid or unenforceable, it will not affect the validity or enforceability of any other provision. This limited warranty constitutes the entire agreement of the parties, and no waiver or amendment shall be valid unless it is in written form and signed by an authorized representative of Kaindl.

KAINDL DISCLAIMS ALL OTHER EXPRESS OR IMPLIED WARRANTIES, INCLUDING ANY IMPLIED WARRANTY OF MERCHANTABILITY OR FITNESS FOR A PARTICULAR PURPOSE, WITH RESPECT TO THE PLANKS

Aqua Genius Collection is manufactured in accordance with Kaindl's Aquapro selected planks' specifications.